

PLANO DE MARTILLOS

ESCALA = 1:100

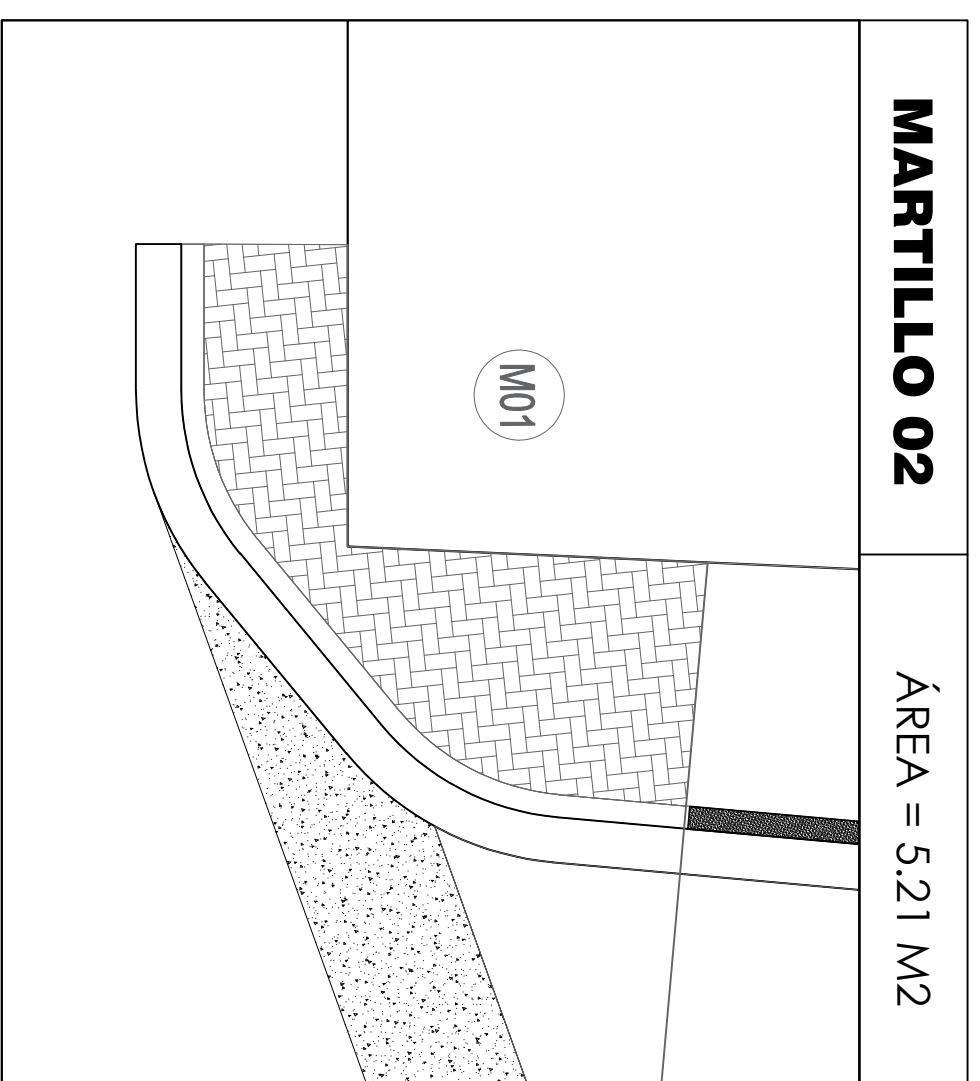

MARTILLO 02 ÁREA = 5.21 M2

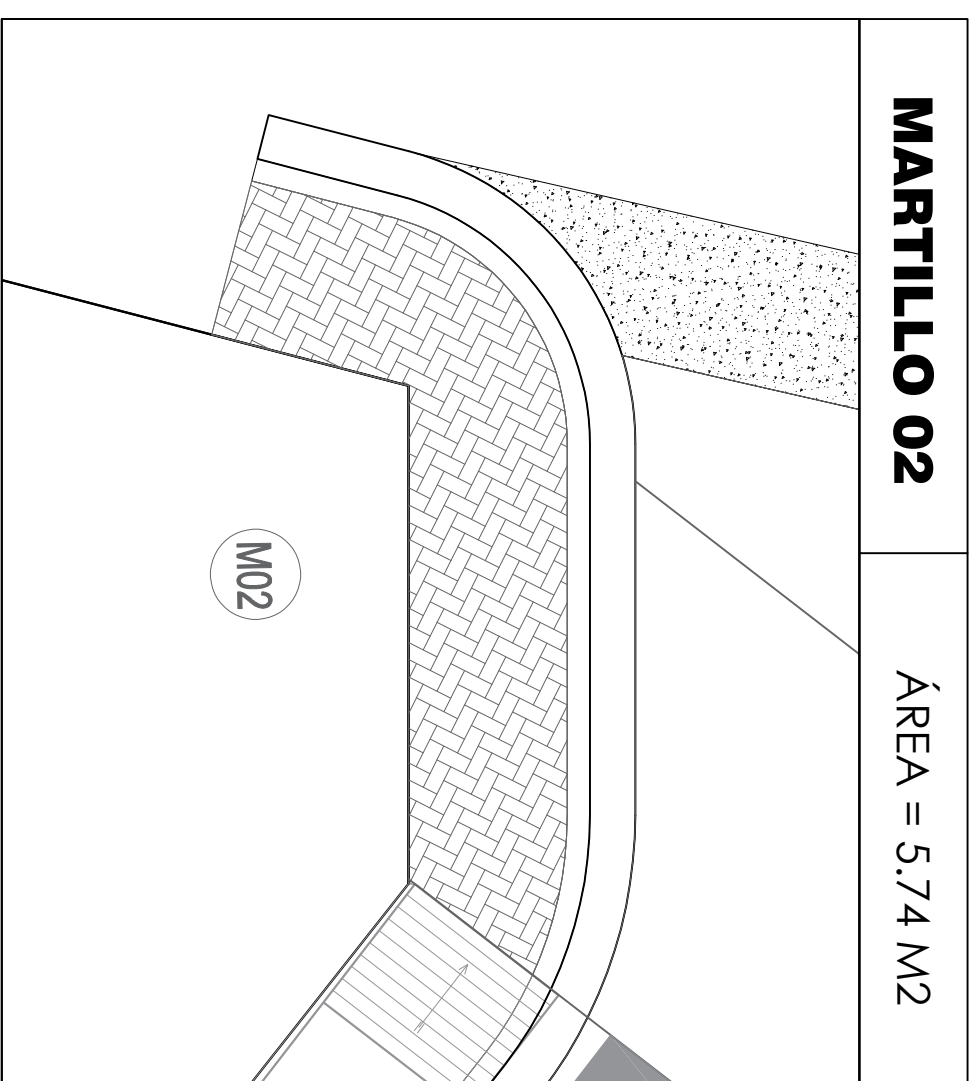

MARTILLO 02 ÁREA = 5.74 M2

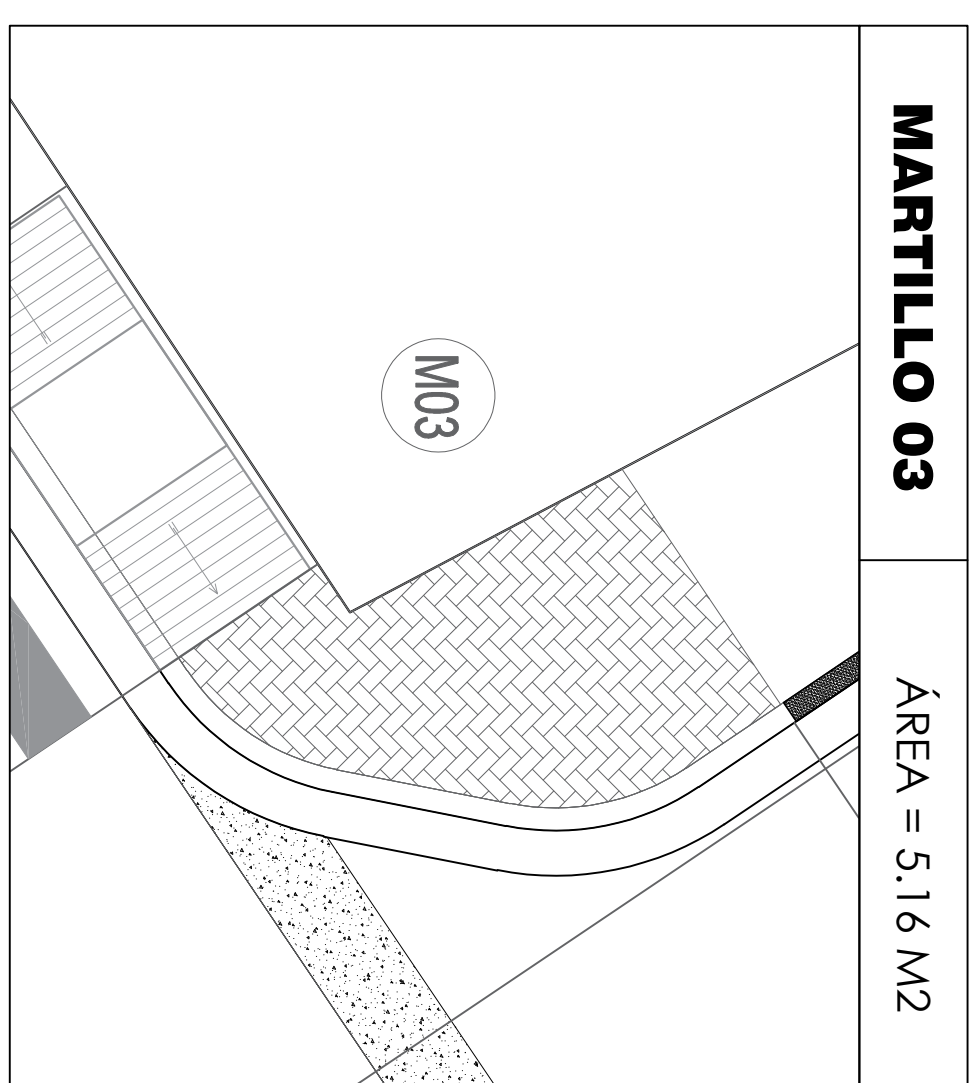

MARTILLO 03 ÁREA = 5.16 M2

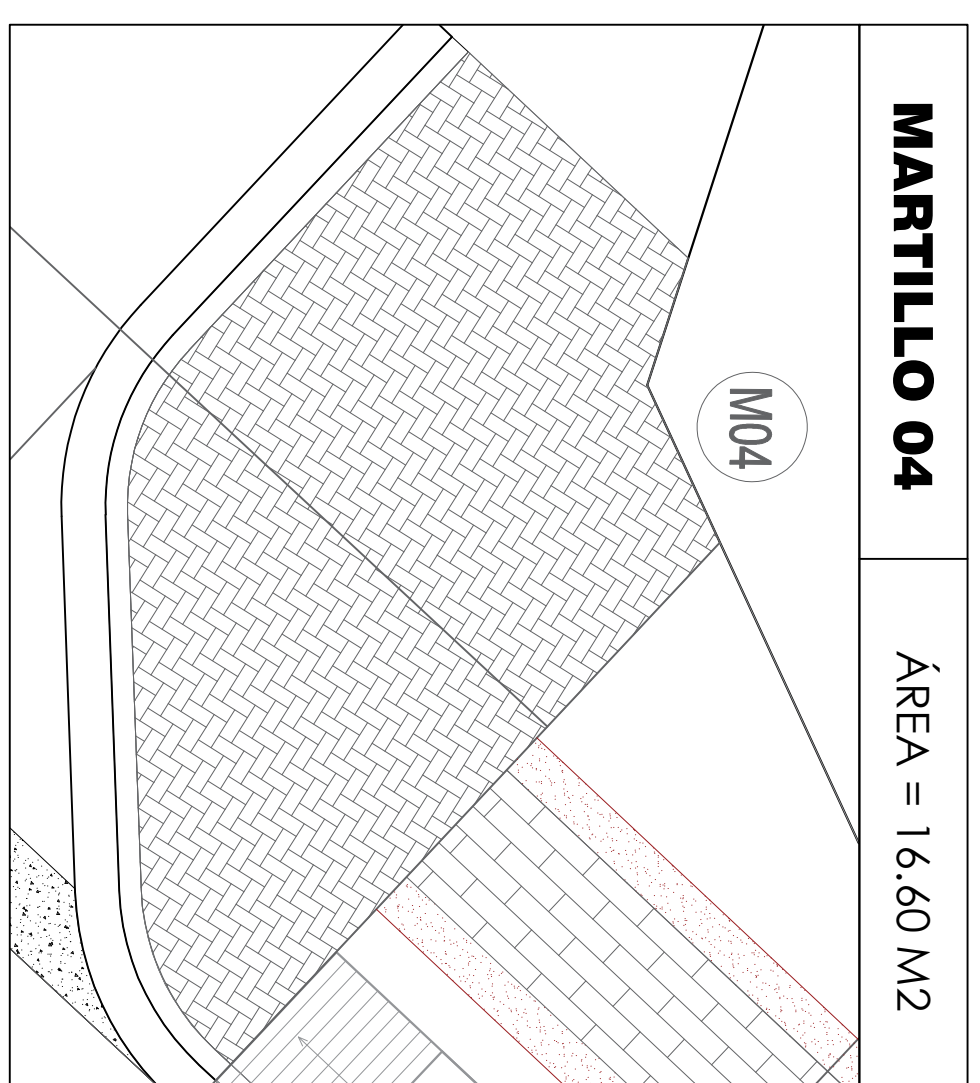

MARTILLO 04 ÁREA = 16.60 M2

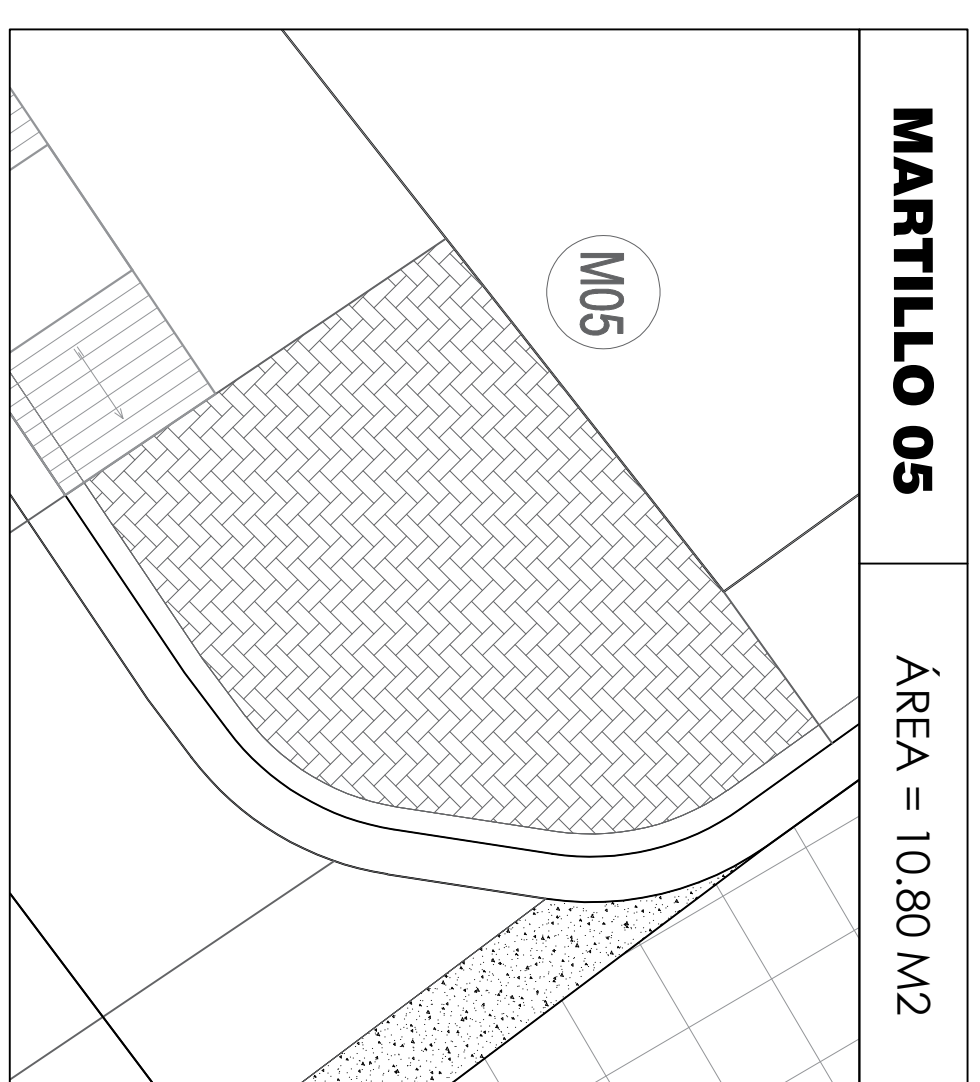

MARTILLO 05 ÁREA = 10.80 M2

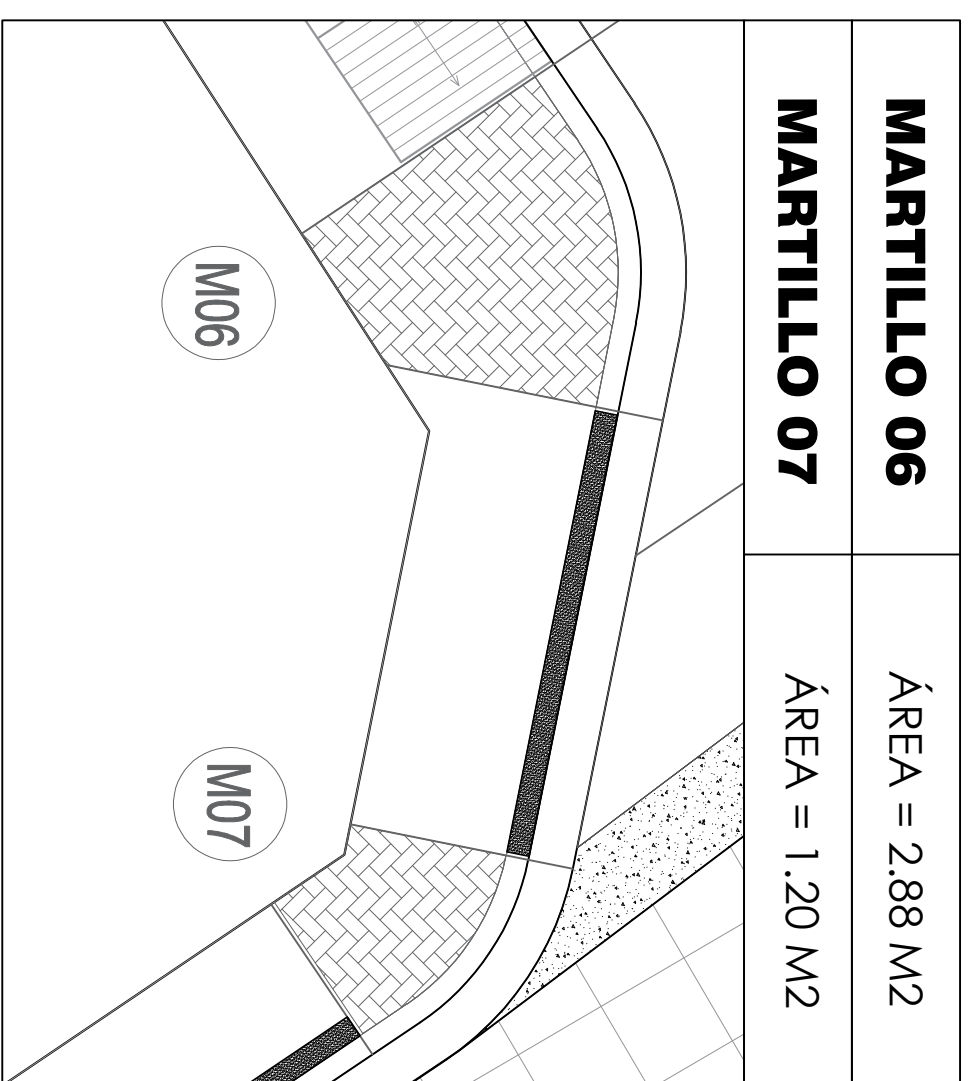

MARTILLO 06 ÁREA = 2.88 M2
MARTILLO 07 ÁREA = 1.20 M2

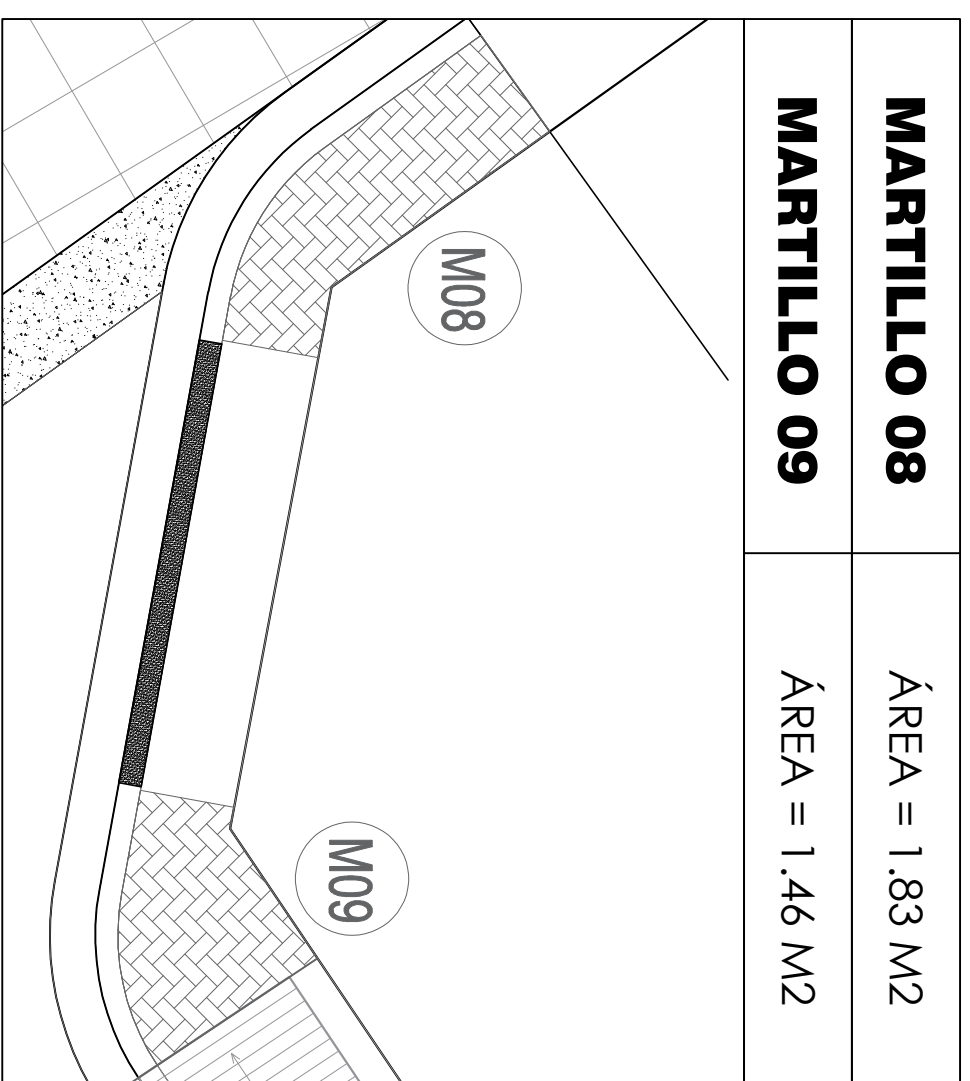

MARTILLO 08 ÁREA = 1.83 M2
MARTILLO 09 ÁREA = 1.46 M2

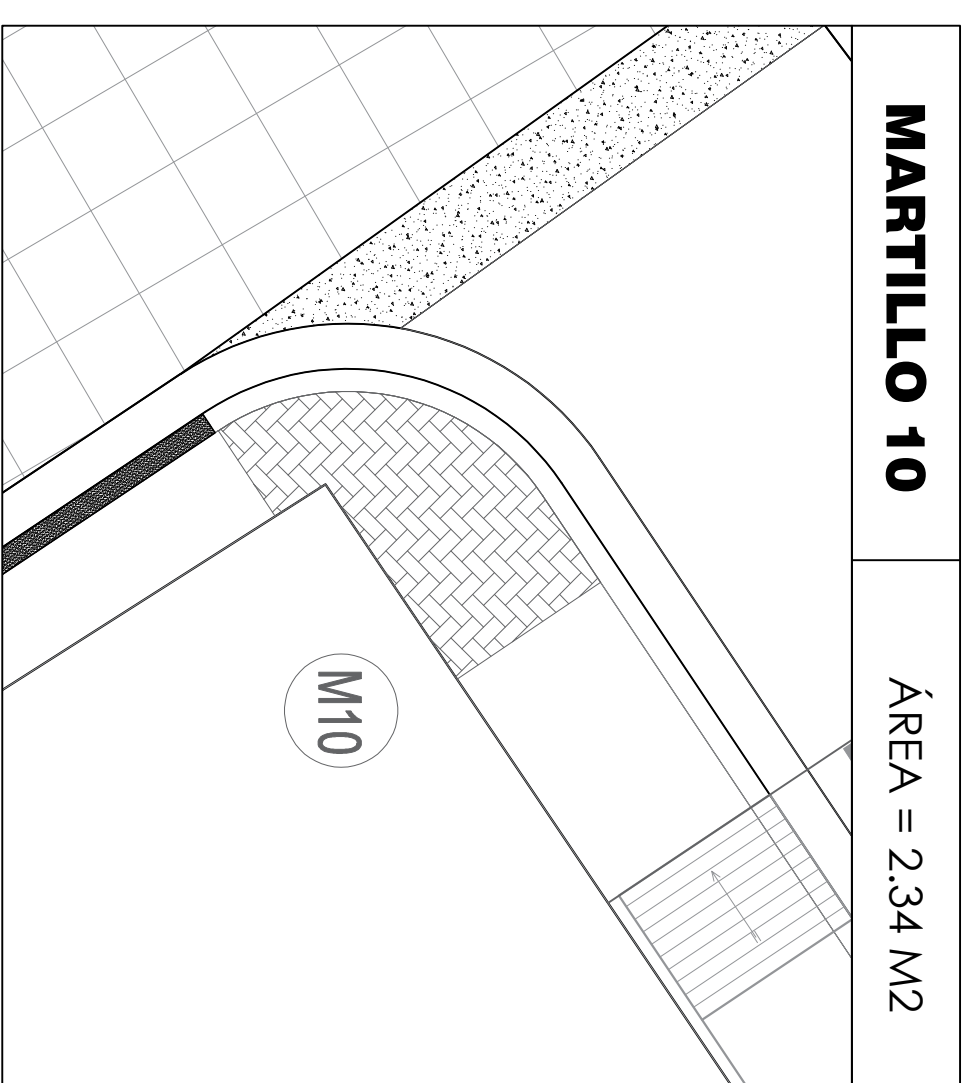

MARTILLO 10 ÁREA = 2.34 M2

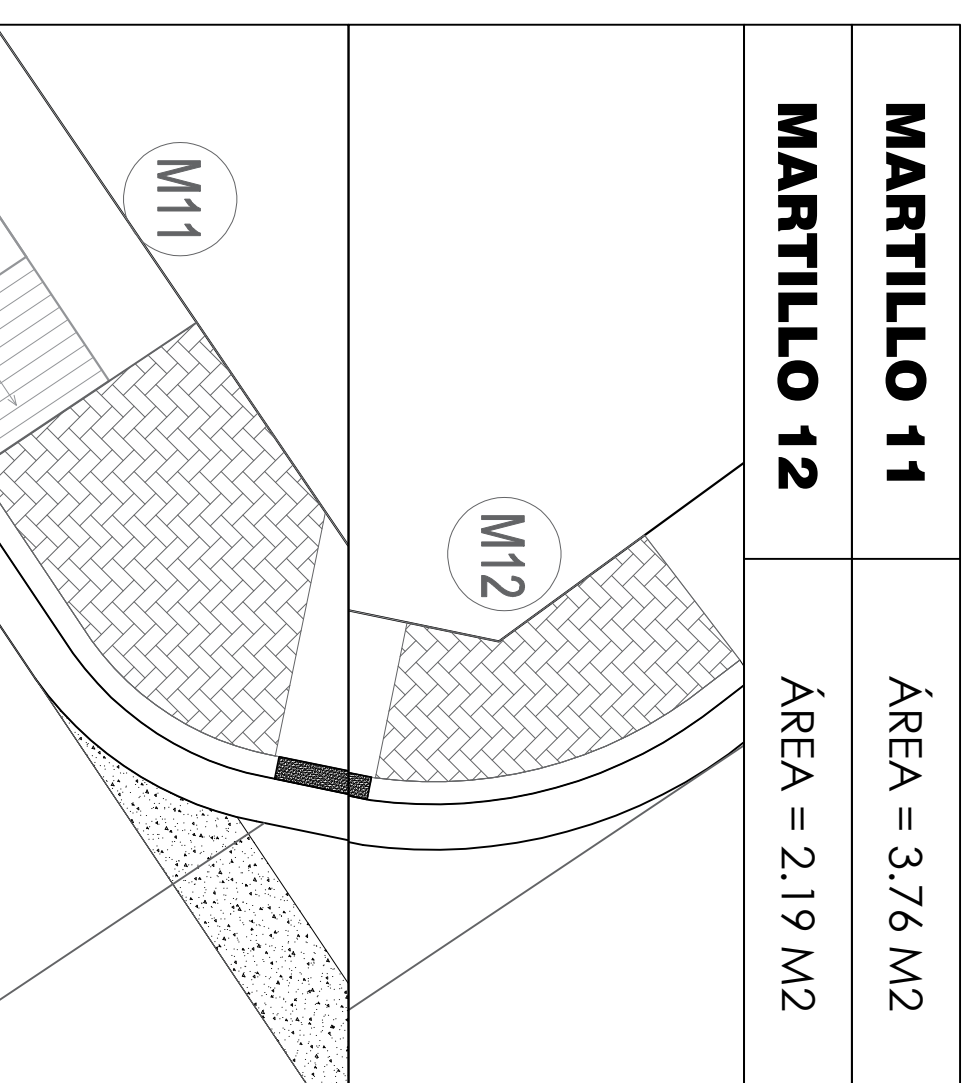

MARTILLO 11 ÁREA = 3.76 M2
MARTILLO 12 ÁREA = 2.19 M2

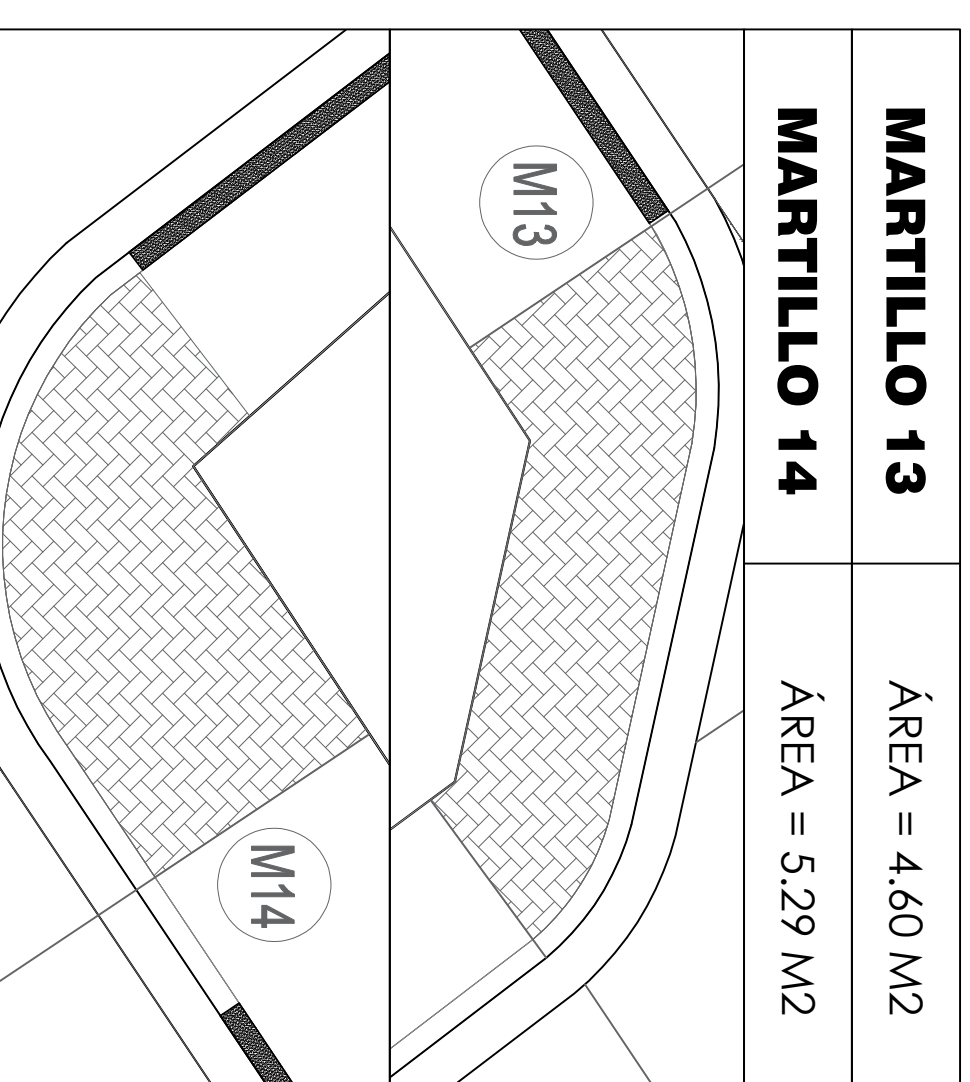

MARTILLO 13 ÁREA = 4.60 M2
MARTILLO 14 ÁREA = 5.29 M2

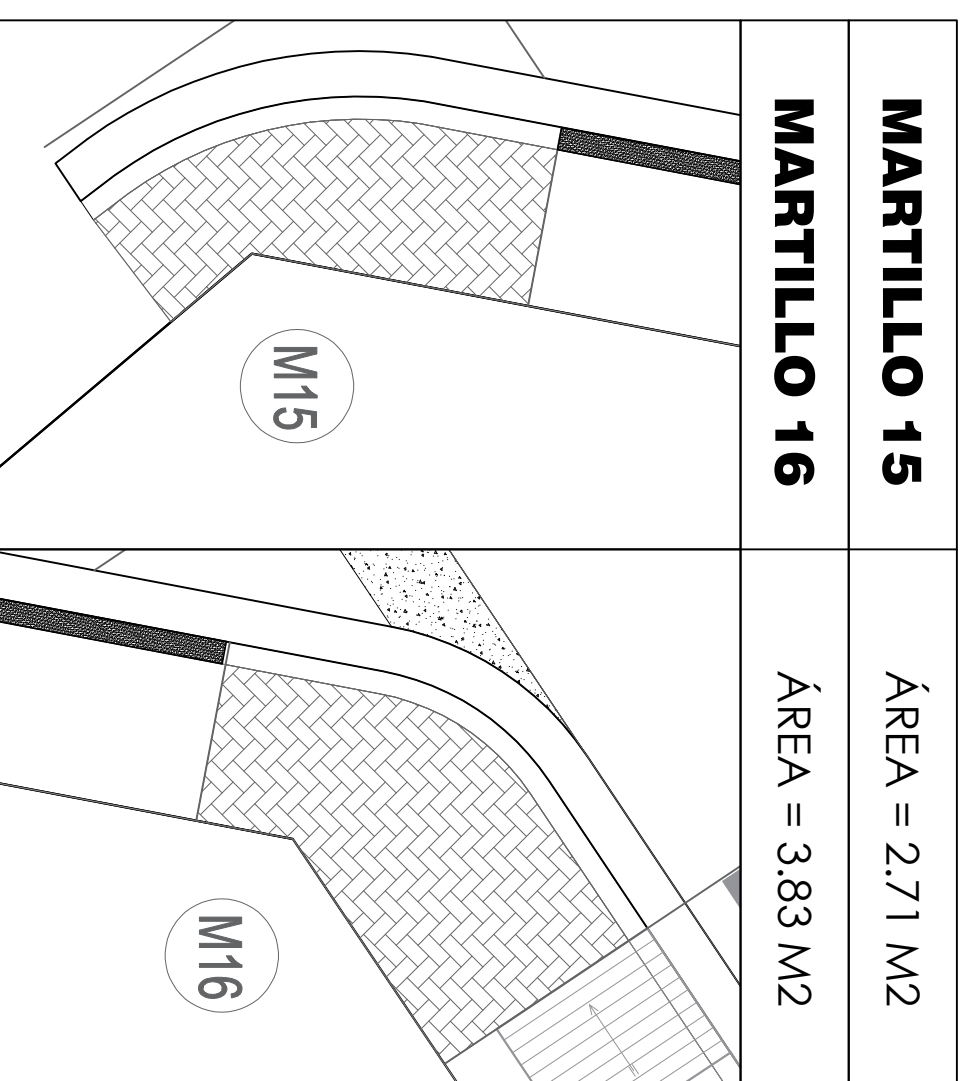

MARTILLO 15 ÁREA = 2.71 M2
MARTILLO 16 ÁREA = 3.83 M2

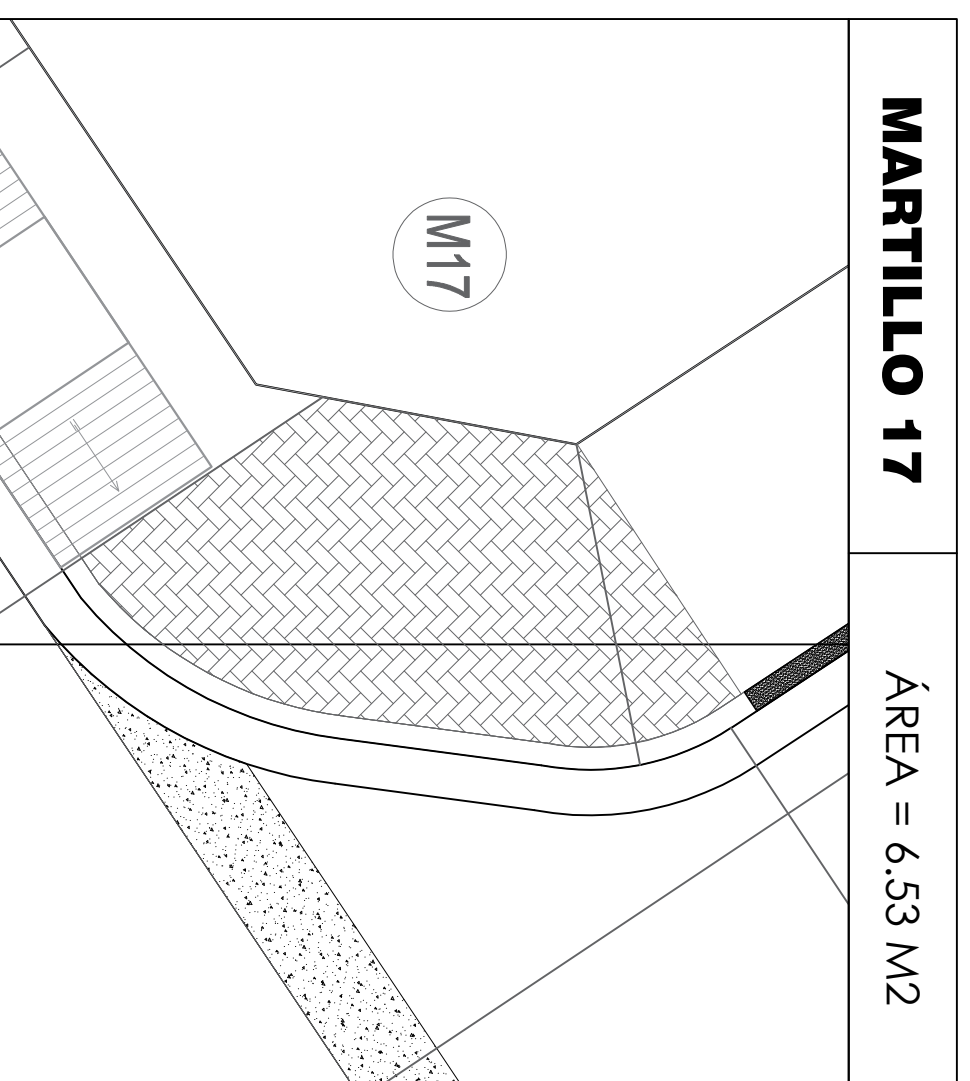

MARTILLO 17 ÁREA = 6.53 M2

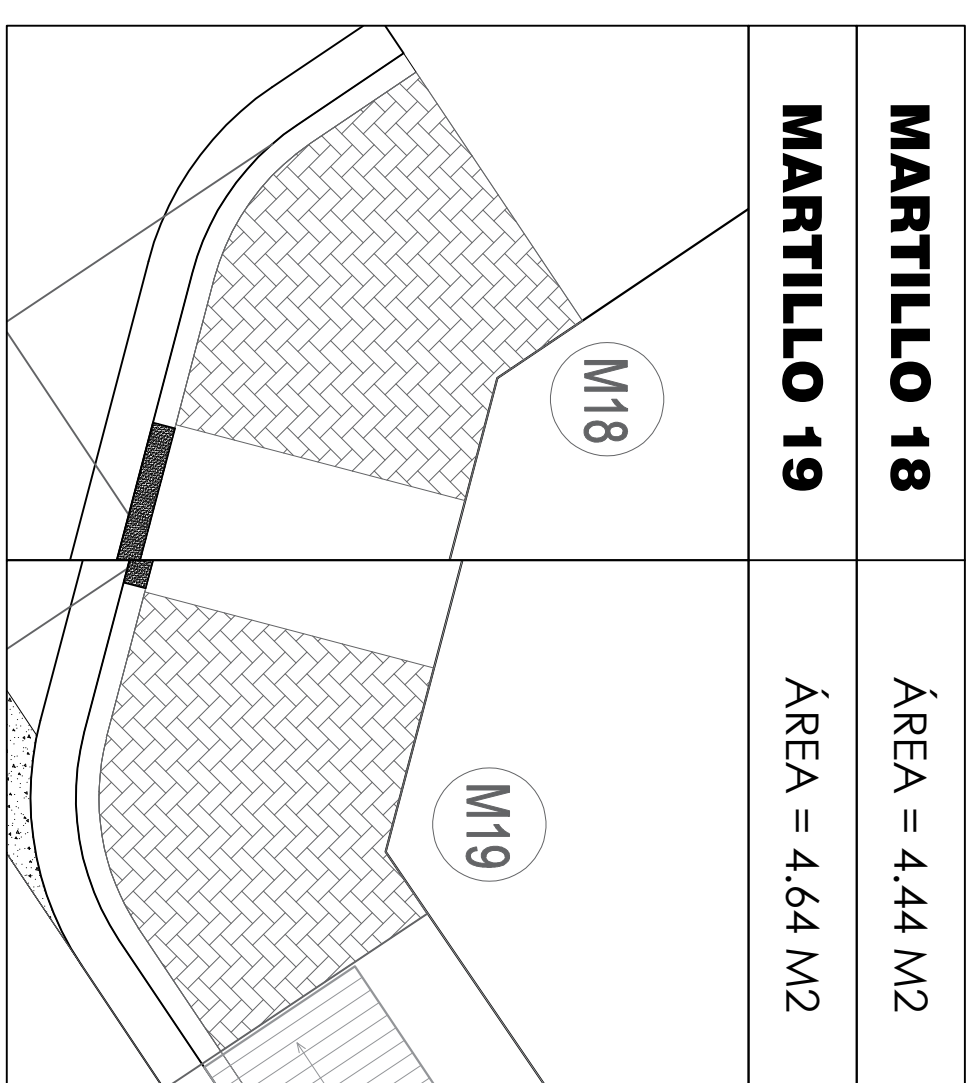

MARTILLO 18 ÁREA = 4.44 M2
MARTILLO 19 ÁREA = 4.64 M2

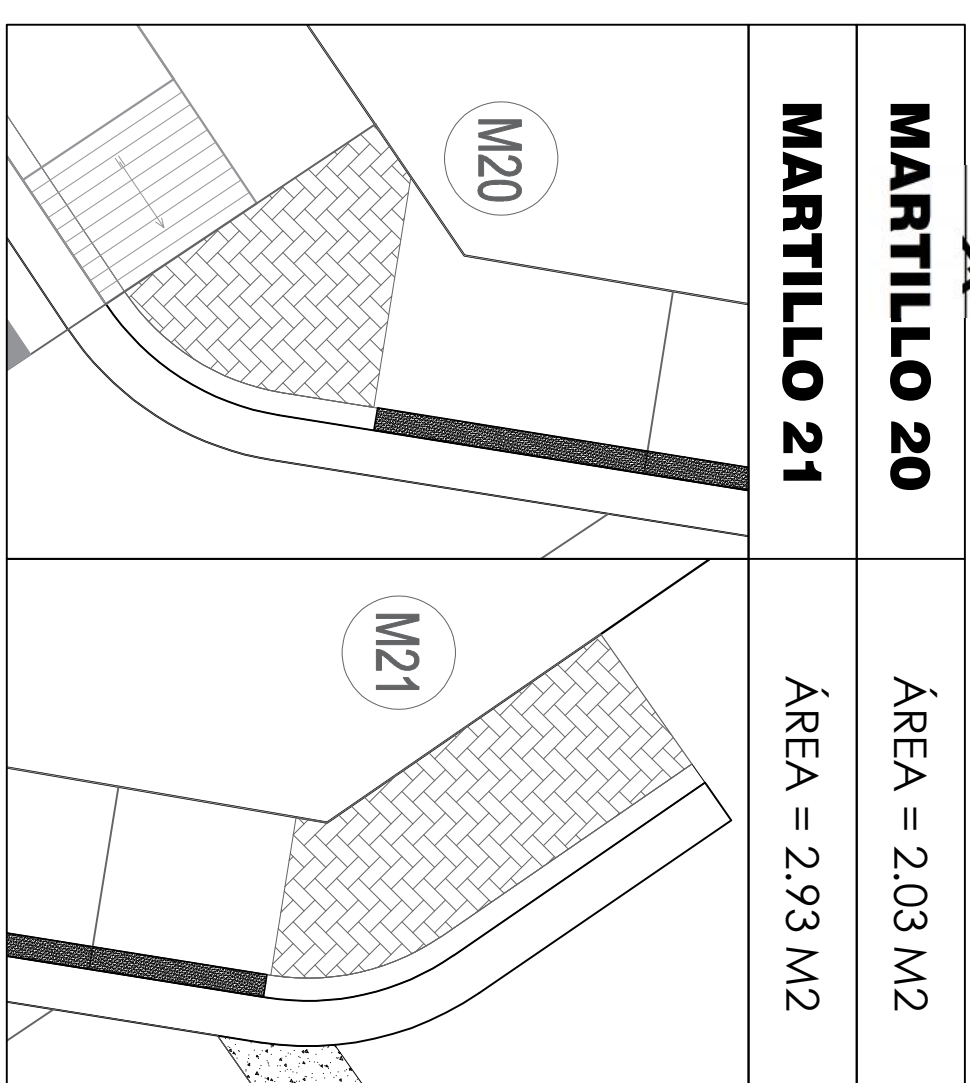

MARTILLO 20 ÁREA = 2.03 M2
MARTILLO 21 ÁREA = 2.93 M2

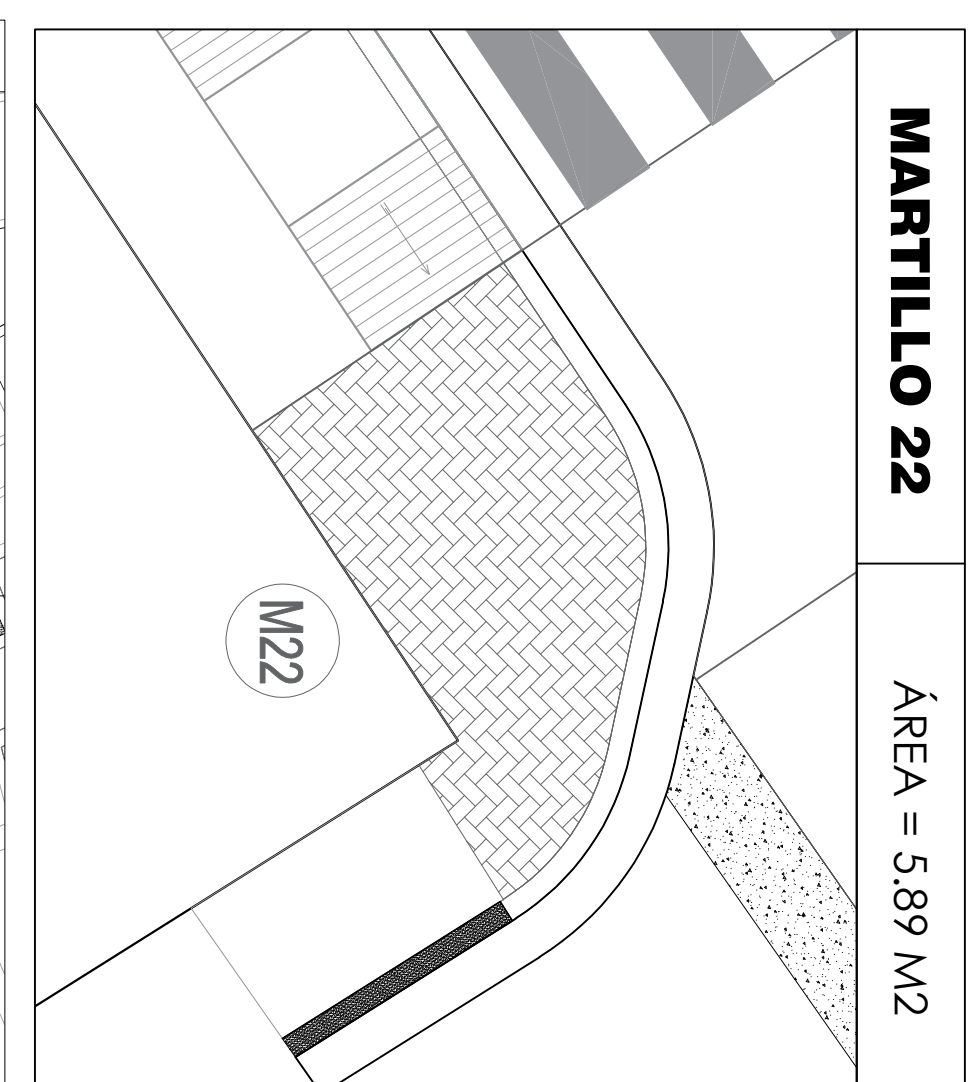

MARTILLO 22 ÁREA = 5.89 M2

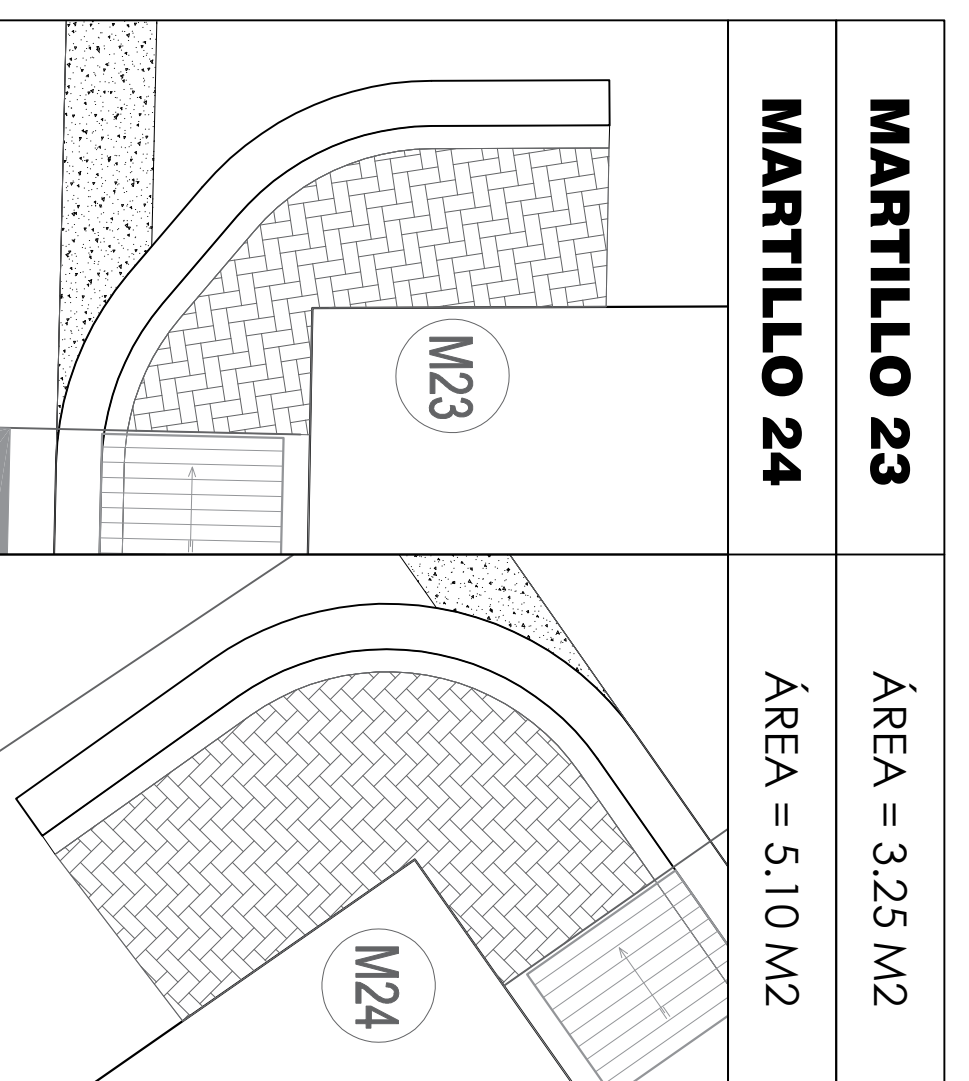

MARTILLO 23 ÁREA = 3.25 M2
MARTILLO 24 ÁREA = 5.10 M2

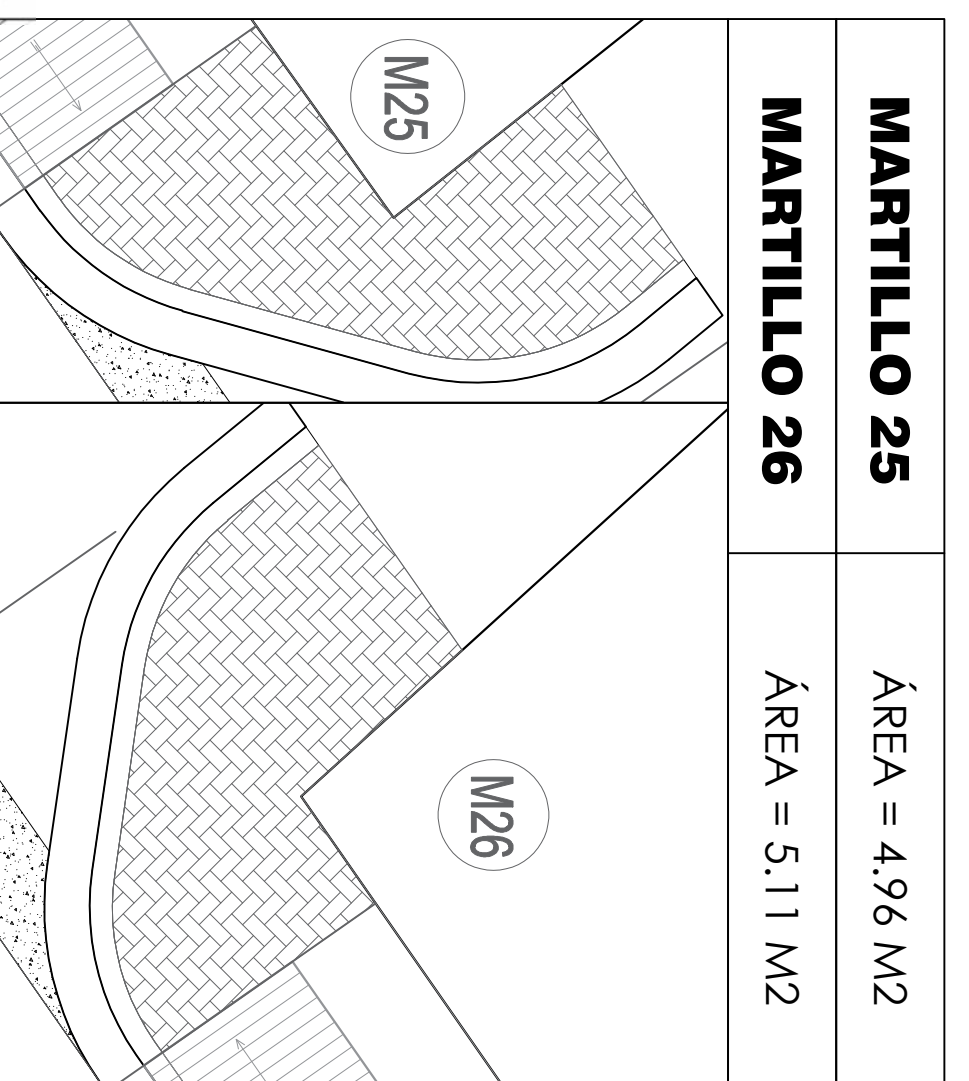

MARTILLO 25 ÁREA = 4.96 M2
MARTILLO 26 ÁREA = 5.11 M2

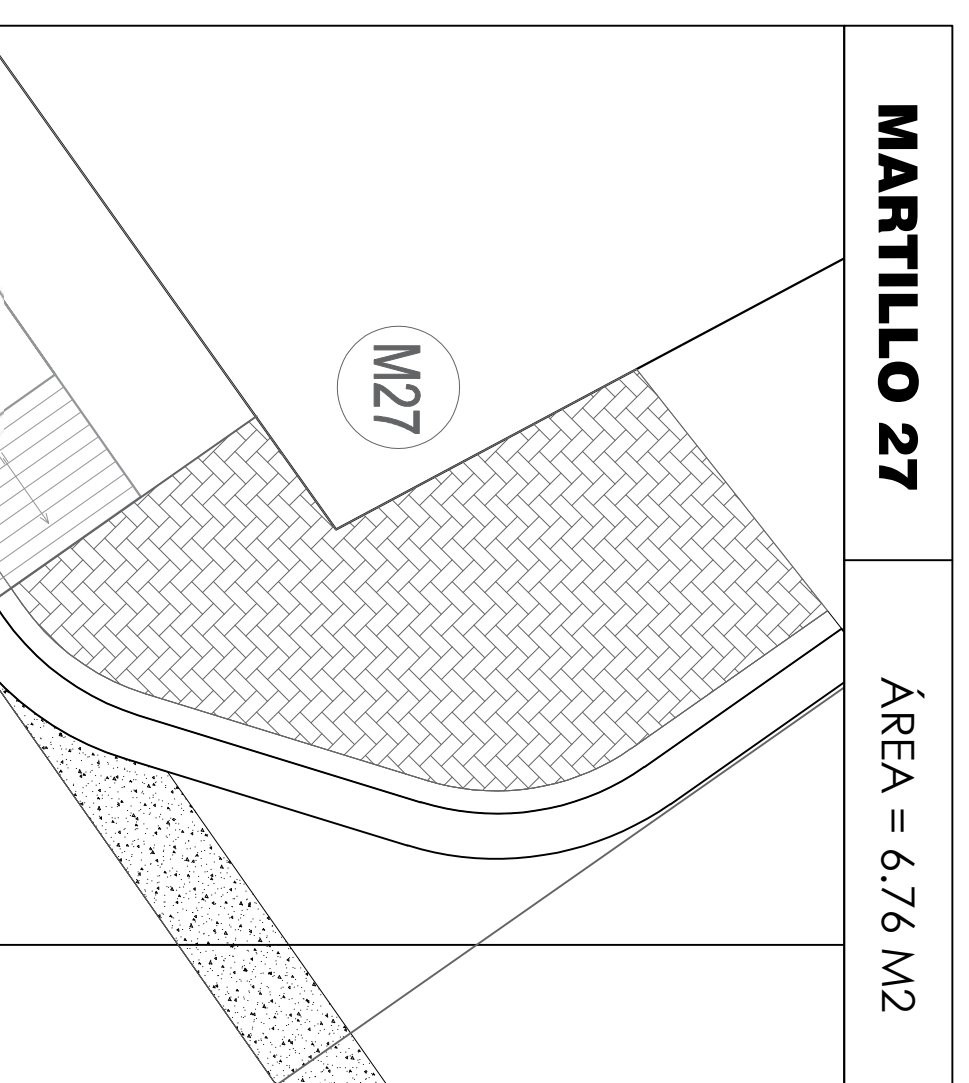

MARTILLO 27 ÁREA = 6.76 M2

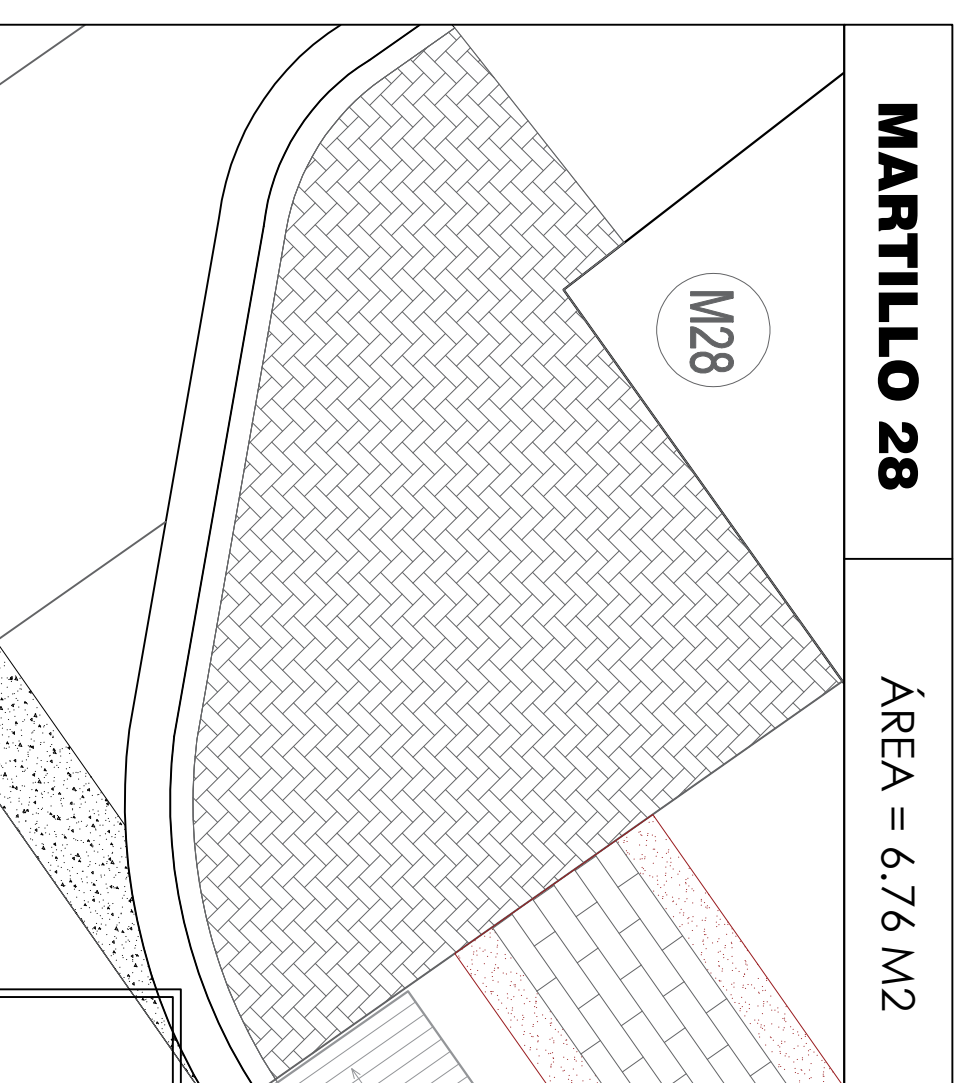

MARTILLO 28 ÁREA = 6.76 M2

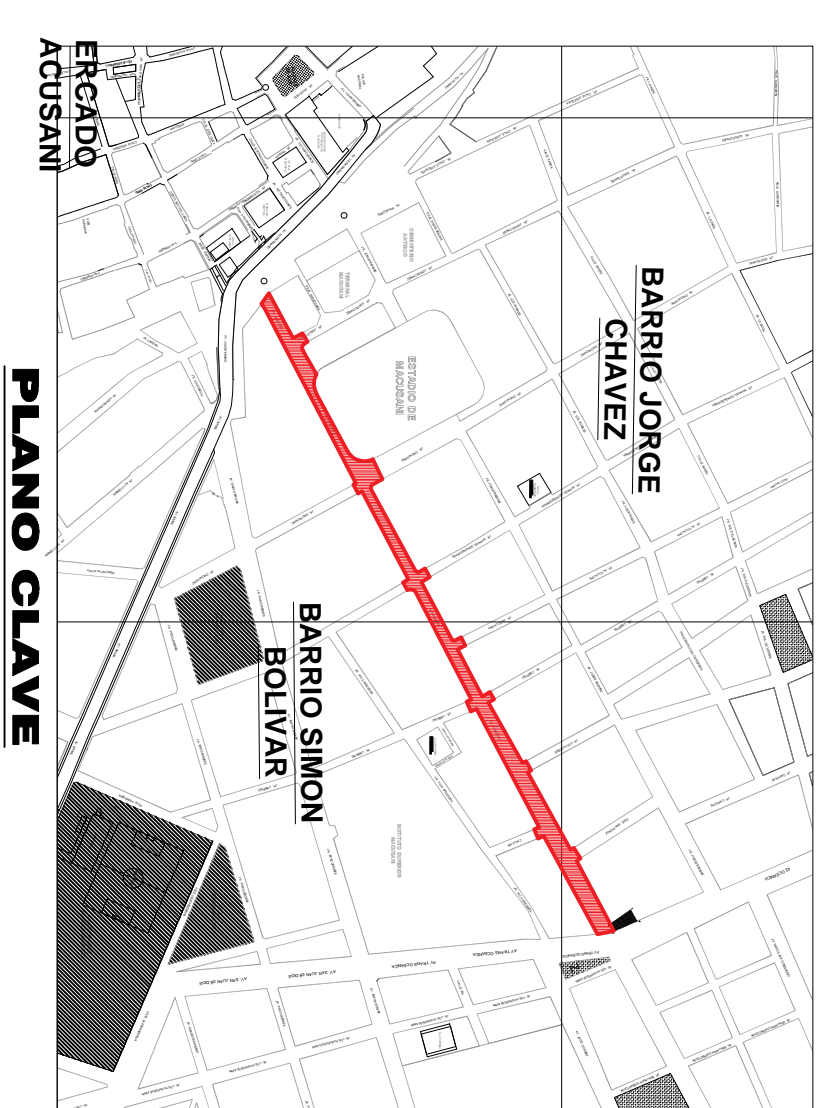

PROYECTO: MEJORAMIENTO DEL SERVICIO DE TRANSITO PEATONAL Y VEHICULAR EN EL JIRÓN AVACLEHO DE LA CIUDAD DE MACULI, PROVINCIA DE CABAÑA - PUNO
FINANCIAMIENTO: MUNICIPIALIDAD PROVINCIAL DE CABAÑA
GESTIÓN: 2019 - 2022

INSTITUCIÓN: INSTITUTO NACIONAL DE VIALIDAD
DISEÑO: INVIAS
ELABORACIÓN: INVIAS
REVISIÓN: INVIAS
APROBACIÓN: INVIAS

